

Formula Student Germany 2022

Team Briefing for Thursday, 18th of August



16.08.2022

General Information



- We recommend regular COVID-19 tests to all team members
- **The panoramic picture will be postponed – we will keep you updated**

Static Events



Cost & Design:

- Check your team's judging times in your account today.formulastudent.de
- Be at the "Erbeerkörbchen/Strawberry Basket" in time (**min. 1h before the judging slot**)
- Check in advance where the entrance for team members and the car is
- No use of the second elevator (it is only for the party equipment for the Mahle Party)



Judging of DV-Cup-Teams – Overlap with DV-Dynamics:

- The six participants of the DV cup will get a Fast-Lane-Ticket for the “Erdbeerkorbchen/Strawberry Basket” to go down at first (already gained inspection stickers for order)

BPP:

- Business Plan Finalist will be announced only appr. **30 minutes prior the finals** – be prepared and onsite if you feel confident

Erdbeerkörbchen/Strawberry Basket

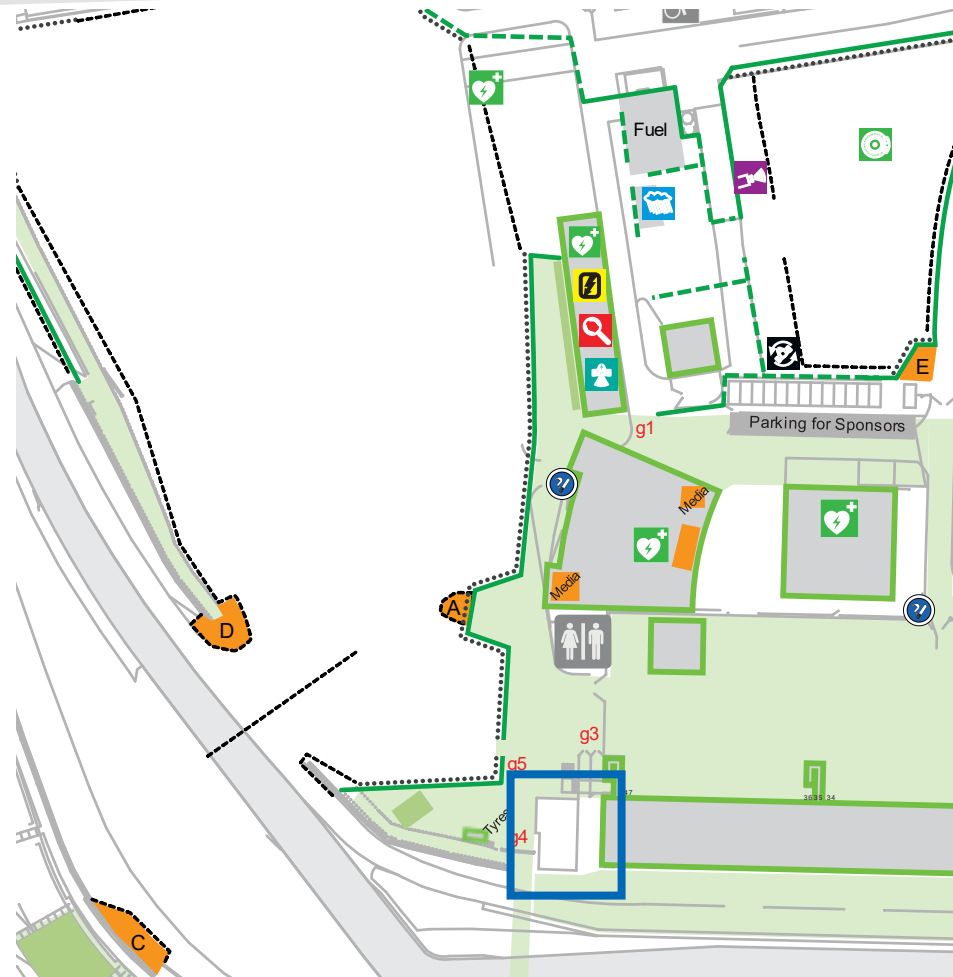

How-to-dynamics



- Arrive at the event when you wish to do your run – no hanging around pointlessly
- Speculating in “late run” for certain track conditions is YOUR gamble
- Ready to race = car in ready condition
- Scrutineers will do spot checking on all of these on all events
- Handheld umbrellas only. No tents, tarps, pavilions etc.
- We will handle the cleanliness of the dynamic area. Don't bring brooms

Dynamics - Practice area

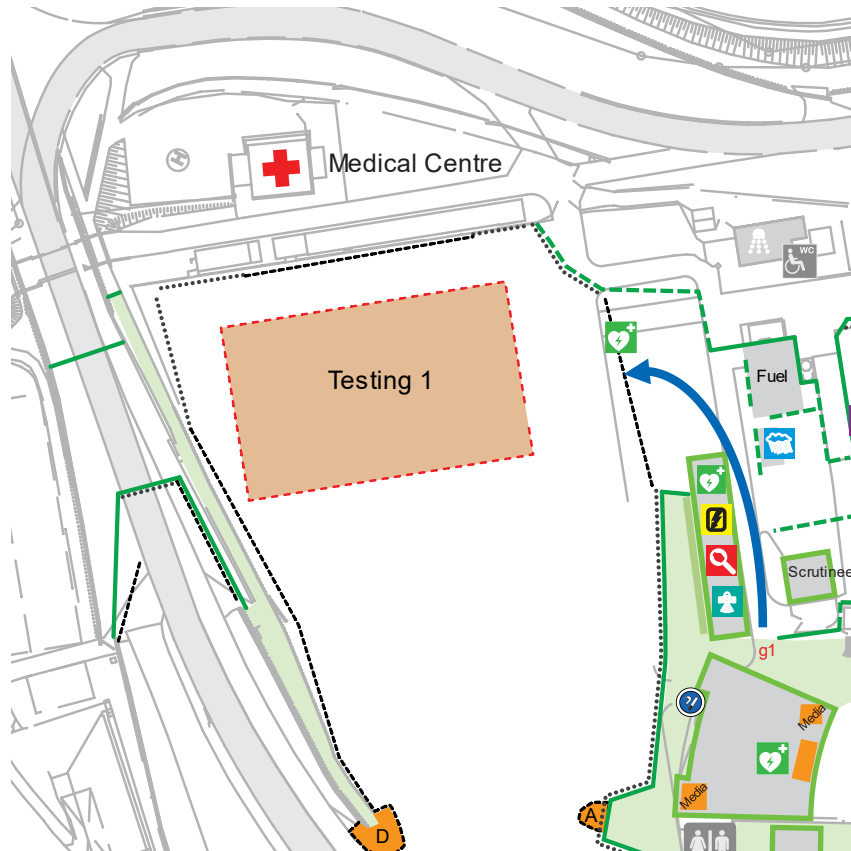

Practice Area

- Dynamic A: 8:00 to 18:30
- Access via gate 1
- Track time 3 - 5 min / run
- Sign in the list at the marshals
- Running order is list based
- After testing please take all your equipment with you

Dynamics - Practice area

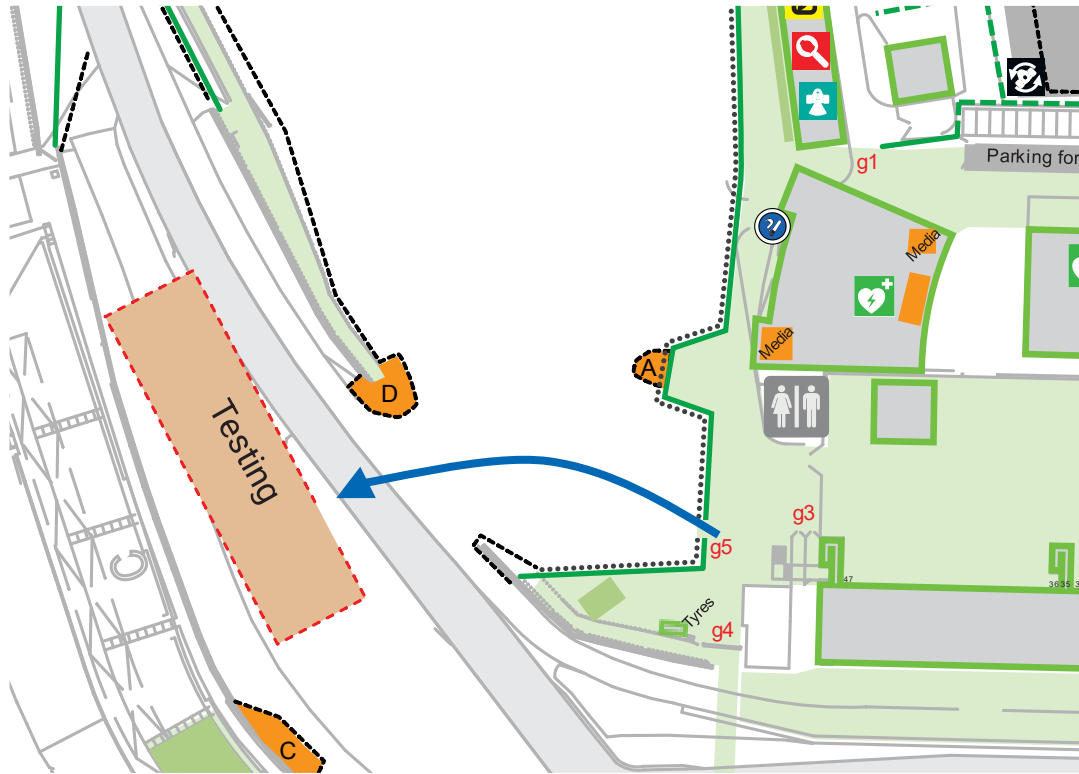

Practice Area

- Test Area B: 8:00 to 18:30
- Access via gate 5
- Track time 3 - 5 min / run
- Sign in the list at the marshals
- Running order is list based
- After testing please take all your equipment with you

Dynamics – Driverless Skidpad

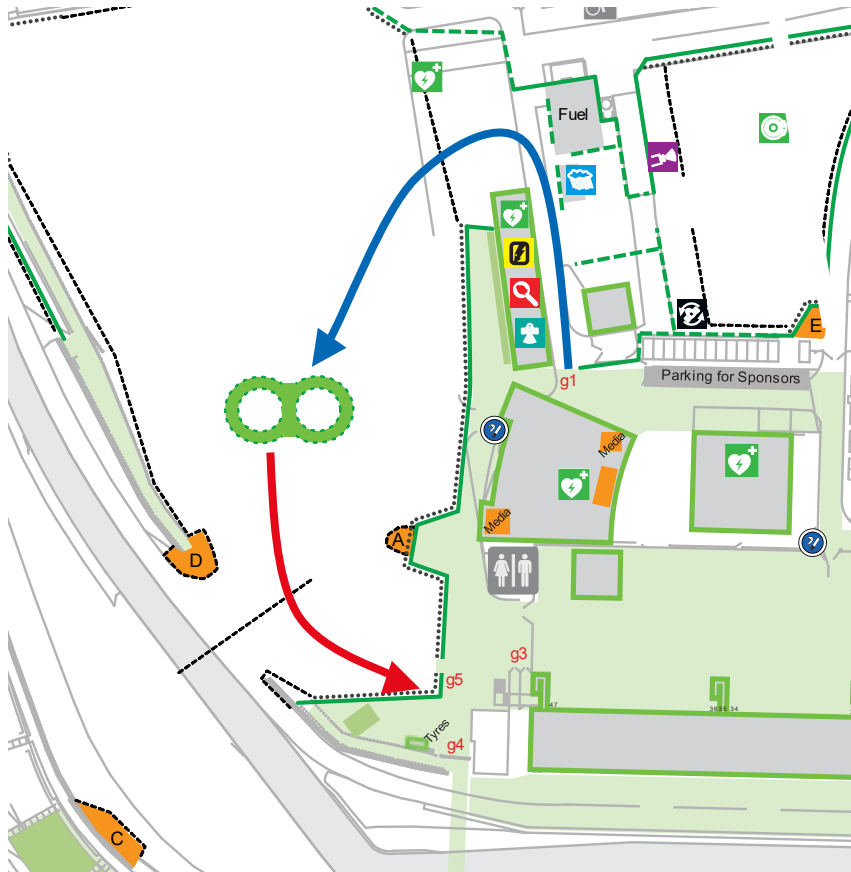

Driverless Skidpad

- Dynamic B: 15:00 to 19:00
- Entry via gate 1
- Exit via gate 5
- We planned enough time - you are responsible to show up in time
- In the last hour there might be long queues
- Please keep in mind rules D2.5 & D9.1.16

Dynamics – Driverless Skidpad



- 2 runs per team
- 2 laps to the right, 2 laps to the left.
- Two lane queue – one for “1st run” and one for “2nd run”
- Teams on their 1st run will be given priority
- **Penalties**
 - cone down or out (DOO): 0,2 sec
 - off course (OC): DNF
 - Wrong number of laps: DNF
 - Wrong direction: DNF

EBS Test



- EBS Test will be on request at Start/Finish Line
- Time 9:00 – 12:00 and 13:00 – 19:00